

**Wheatgrass and juicer details are mentioned hereunder.
This is for UAE only.**



A 13 inch diameter Wheatgrass tray which is capable of giving 9-10 shots of wheatgrass juice of 30 ml each depending on the kind of juicer used.

One tray costs Aed 50, plus Aed 10 is a non refundable deposit. This is charged only the first time as we expect you to bring the empty tray in the next orders that you make so that we transfer the grass in your tray and not charge the deposit again..

We also sell cut grass packets each of 250 gms costing Aed 40 each and is capable of giving 6-7 shots of 30 ml each depending on the juicer used.. Extra delivery charges are added depending on the location it is delivered to.



Starter kits to grow wheatgrass consists of 2 round trays, Soil and seeds enough to make one tray of wheatgrass costs Aed 45.

Delivery charges are not added for any product you buy if orders are picked up from our delivery locations.

Delivery days are Sundays in Dubai mall or Diera city centre

Wednesdays in Deira City Center, Dubai Mall and Ibn Batuta. This may change depending on the business.

Location in Sharjah :

Once you reach the Rolla area near Rotana Hotel on your right, While over the bridge, keep going straight until you see Fine Fair Garment store. It has a huge green colour board. Immediately after this you will see a roundabout. Take a full U turn and come on the opposite road of the same **Fine Fair garment store**. Now get off road to turn right and you will see a building that reads STUDIOS. Our shop is on the back side of this building. ALNoor Al Akhdhar.

Timing is from 8 AM to 12 Noon and 3 PM to 5 PM

Call us on 0558406006

Email : md@alnoorwheatgrass.com

Wheatgrass Juicers

BL30 Manual Stainless Steel Juicer



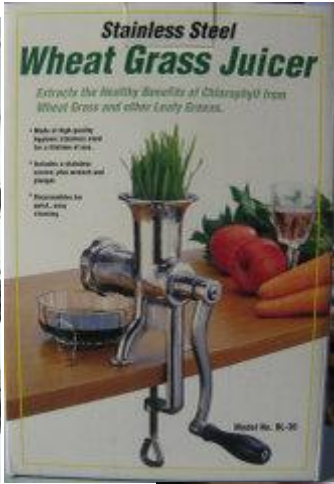

•
Cost Aed 700

MANUAL LEXEN HEALTHY JUICER – THE BEST OPTION FOR BEGINNERS





Cost Aed 300

**BL34 STAINLESS STEEL COMMERCIAL ELECTRONIC JUICER
BEST FOR COMMERCIAL BUYERS**



**Cost is AED 3,700
Details are on the next page.**

IMPORTANT. PLEASE READ THESE INSTRUCTIONS BEFORE OPERATING THE JUICER...

The M-34 commercial grade wheatgrass juicer is a low maintenance appliance which extracts the juice from wheatgrass and other soft leafy vegetables and fruit.

Operating the machine is quite simple. Please familiarise yourself with the cleaning and maintenance procedures for trouble free juicing.

ASSEMBLING JUICER

It is important that before assembling or disassembling the juicer disconnect the plug from mains power.

At the end of each day you must disassemble the juicer to clean lubricate it. Please use the wrench (6) provided to remove the top cap (5) if it is too tight. Now remove the wing nuts (7) and the end front end will come apart for cleaning.

Thoroughly wash all parts in warm soapy water and dry. It is good practice to also use food grade petroleum jelly to lubricate the front end of the auger (3) and the white shaft seal. This will help prevent juice entering the motor unit.

Assembling the juicer is just as easy....

1. Insert the screen (2) tapered end first into the housing (1).
2. Insert the auger (3) into the main housing (1) and ensure that the white shaft seal is in place.
3. With the gasket inserted (4) fasten the housing (hand tighten only).
4. By hand prealign the square end of the auger (3) to the motor drive. Insert the auger into the motor and fasten together with wing nuts (7).

OPERATING JUICER

Plug your juicer into the mains power and push the switch forward (towards the main housing). Feed the grass into the opening using the pusher (9) if necessary.

When juicing wheat grass cut the grass in bunches 5 cm in diameter feeding it head first. Initially you will need to feed about 3 bunches to get the juicing process started.

Wheatgrass juice is best served immediately after juicing.

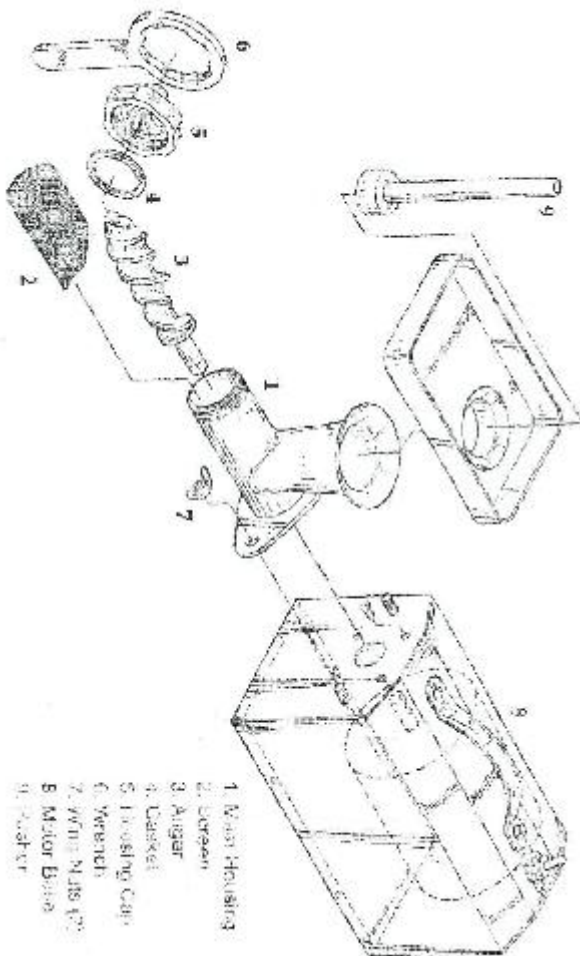

1. Main Housing
2. Screen
3. Auger
4. Gasket
5. Top Cap
6. Wrench
7. Wing Nuts
8. Motor Drive
9. Pusher

Ps feel free to call or email for more information

Rozina
0559406006

